

NOTES:

1. WATER SERVICE CO-ORDINATOR:  
RMA INFRASTRUCTURE PTY LTD  
SHOP 6 - 2 CASTLEREAGH STREET PENRITH N.S.W 2750  
PH. 4722 2774. REFERENCE No.W-10973  
FOR  
SEED PROJECTS AUSTRAL No.2 PTY LTD  
C/- MATTHEW CAUSLEY  
PO BOX 455  
BONDI NSW 2026  
Ph: 0411 963 156
2. ALL LOTS WERE VACANT AT TIME OF SURVEY.
3. MAIN TO BE LAID AS SHOWN GENERALLY AT 2.9m P.L AT STANDARD DEPTH EXCEPT WHERE OTHERWISE SHOWN.
4. MAINLAYING NOT TO PROCEED PRIOR TO THE FORMATION OF FOOTPATHS TO FINISHED LEVELS. IF MAINS ARE LAID PRIOR TO THIS IT IS THE CONTRACTOR'S RESPONSIBILITY TO ASCERTAIN THE CORRECT LOCATION & FINISHED LEVELS OF KERBS, FOOTPATHS, ETC.
5. PRECAUTIONS MAY BE NECESSARY IN THE VICINITY OF SUB-STATION EARTHING.
6. CURRENT SERVICES SEARCH & SITE CHECK OF ALL EXISTING SERVICES WILL BE NECESSARY PRIOR TO THE COMMENCEMENT OF WORK & APPROPRIATE PROCEDURES, PRECAUTIONS AND CARE NEED TO BE TAKEN BY THE CONSTRUCTOR WHEN WORKING IN CLOSE PROXIMITY TO SERVICES. THE CONSTRUCTOR IS TO VERIFY THE EXACT LOCATION OF ALL EXISTING SERVICES DURING CONSTRUCTION AND ANY DAMAGE TO EXISTING SERVICES IS TO BE RECIPIED AT THE CONSTRUCTORS EXPENSE.
7. THE CONSTRUCTOR IS TO VERIFY THE EXACT LOCATION AND LEVELS OF ALL SERVICES PRIOR TO CONSTRUCTION.
8. FIELD COMPACTION TESTS REQUIRED TO BE UNDERTAKEN TO SATISFY THE WATER SUPPLY CODE OF AUSTRALIA SYDNEY WATER EDITION 2014 (WSA 03-2011-3.1). IT IS THE LISTED FIELD TESTERS RESPONSIBILITY TO ENSURE THE CORRECT NUMBER OF TESTS ARE CARRIED OUT TO SATISFY THE SEWAGE CODE OF AUSTRALIA AS PER SYDNEY WATER'S INSTRUCTIONS TO FIELD TESTERS CLAUSE 3.
9. ALL WORKS TO BE CONSTRUCTED IN ACCORDANCE WITH THE FOLLOWING  
(a) DEEMED TO COMPLY DRAWINGS DTC 1110, DTC 1112, DTC 1113, DTC 1114.  
(b) THE WATER SUPPLY CODE OF AUSTRALIA - WSA 03-2011-3.1 (SYDNEY WATER EDITION 2012) INCL. THE SYDNEY WATER SUPPLEMENT (2014) AND APPENDICES.  
THE CONTRACTOR MUST HAVE A COPY OF THESE DOCUMENTS ON SITE AT ALL TIMES.
10. ALL VALVES TO BE RESILIENT SEALED AND RESTRAINED IN ACCORDANCE WITH STD. DRG. WAT-1207.
11. FOR MAINS LOCATED IN ROADWAYS LAY AT STANDARD ROAD DEPTH UNLESS NOTED OTHERWISE.
12. DENOTES PROPERTY SERVICE (MAIN TO METER) INSTALLATION REQUIREMENTS.  
THE SERVICE CONNECTION MUST BE CARRIED OUT BY A SYDNEY WATER LISTED DRILLER AND THE INSTALLATION OF THE PROPERTY SERVICE MUST EITHER BE CARRIED OUT OR SUPERVISED BY A LICENSED PLUMBER. THEY MUST MEET THE: a) ADMINISTRATIVE REQUIREMENTS OF THE PLUMBING AND DRAINAGE CODE OF AUSTRALIA.  
b) SYDNEY WATER PROPERTY SERVICE (MAIN TO METER) INSTALLATIONS TECHNICAL REQUIREMENTS.  
IT IS THE CONSTRUCTOR'S RESPONSIBILITY TO LIASE WITH THE HEAD CIVIL CONTRACTOR PRIOR TO INSTALLATION TO CONSTRUCT MAIN TO METER SERVICES CLEAR OF ANY PROPOSED OR FUTURE DRIVEWAYS.
13. FOR MAINS LOCATED IN ANY ROADWAYS TO BE LAID AT STANDARD ROAD DEPTH UNLESS NOTED OTHERWISE.

ENVIRONMENTAL REQUIREMENTS.

- E1. THE REVIEW OF ENVIRONMENTAL FACTORS IS AN INTEGRAL PART OF THIS DESIGN. ALL EROSION AND SEDIMENTATION CONTROL COMPLIED TO THE STANDARDS OF THE SOIL CONSERVATION SERVICE OF N.S.W.
- E2. ALL OPEN STORM WATER GRATES & STORM WATER CHANNELS DOWNSTREAM OF CONSTRUCTION ACTIVITY TO BE ADEQUATELY PROTECTED BY STRAW BALES OR GEOTEXTILE FENCE.
- E3. SILT STOP DEVICES INSTALLED PRIOR TO ANY CONSTRUCTION ACTIVITY, EFFECTIVELY MAINTAINED AND TO BE REMOVED ONLY AFTER THE AREA HAS BEEN SATISFACTORILY RE-VEGETATED.
- E4. SILTATION CONTROL TO BE CARRIED OUT TO THE SATISFACTION OF THE SITE SUPERINTENDENT.
- E5. ALL STOCKPILES OF EXCAVATED MATERIAL TO BE SURROUNDED BY STRAW BALES AND/OR GEOTEXTILE FENCE TO THE SATISFACTION OF THE SUPERINTENDENT.
- E6. SITE RESTORATION TO BE CARRIED OUT TO THE SATISFACTION OF THE SUPERINTENDENT.
- E7. NO TREES OR VEGETATION TO BE REMOVED WITHOUT PRIOR APPROVAL FROM THE

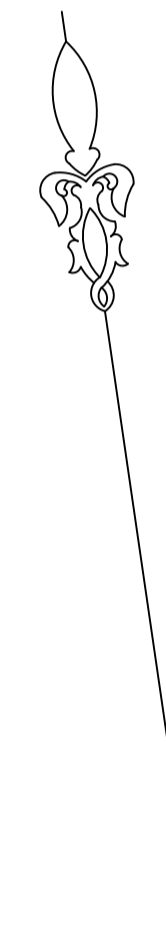
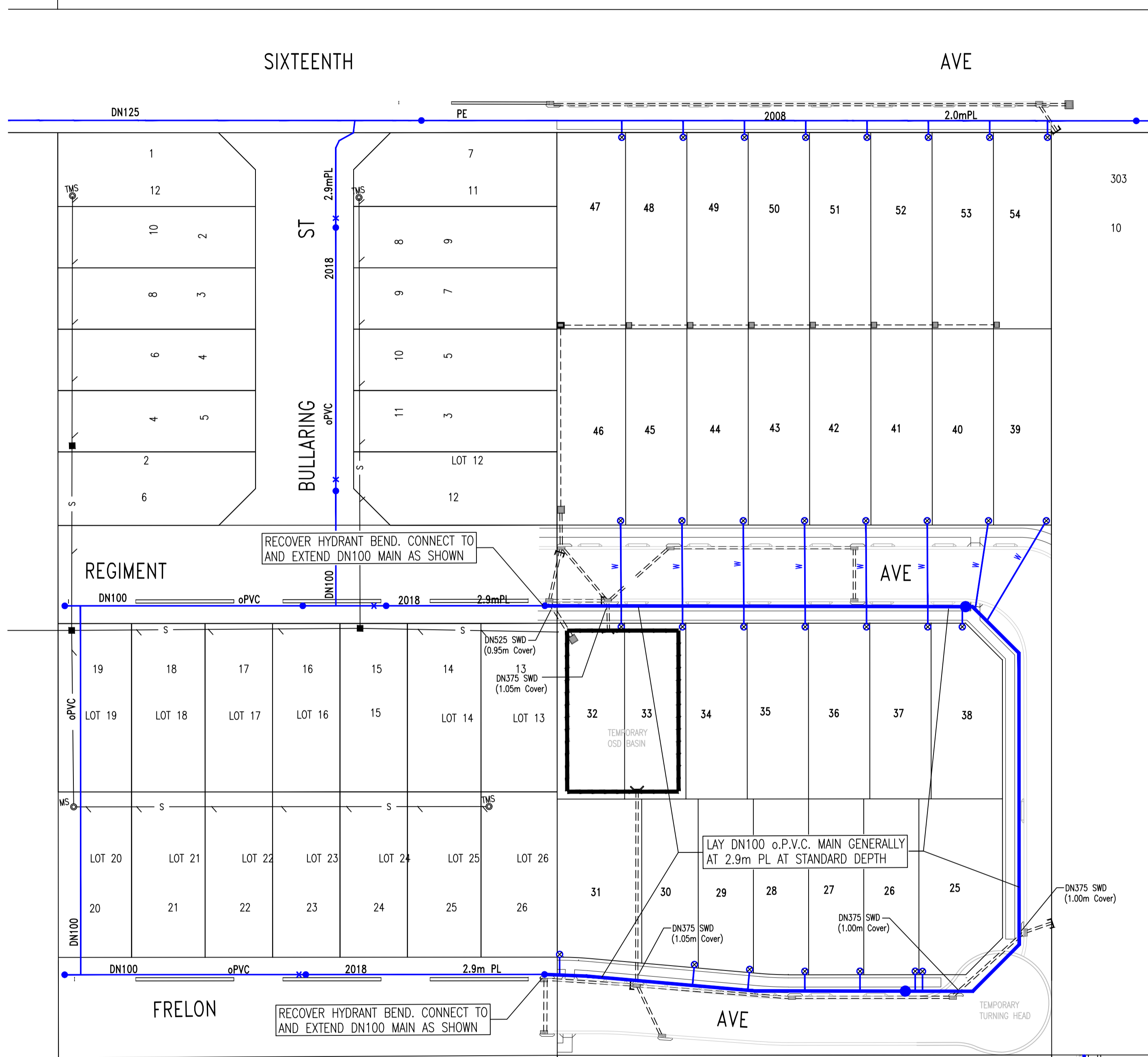

C	REVISED TO SUIT LATEST CIVIL PLANS	NG	30.04.20
B	REVISED TO SUIT LATEST CIVIL PLANS	LD	30.04.18
A	FOR REVIEW	LD	18.04.18
No.	AMENDMENT DESCRIPTION	BY	DATE

PLAN TO BE READ IN CONJUNCTION WITH CURRENT SYDNEY WATER STANDARDS SYDNEY WATER CORPORATION  
 PRIOR TO COMMENCEMENT OF EXCAVATION FOR PROPOSED AND EXISTING SERVICES CONTACT:-  
 DIAL BEFORE YOU DIG Ph: 1100  
 ELECTRICITY Ph:  
 GAS Ph:  
 TELECOMMUNICATIONS Ph:  
 GIVING AT LEAST 48 HOURS NOTICE.

UTILITIES			
TYPE	DATE	REF.	
PROP. STORMWATER: SWD	24.04.20		
SEWER: S	24.04.20		

WORK AS CONSTRUCTED CERTIFICATION		
DEVELOPER	CONSTRUCTOR	DESIGNER
WATER SERVICE CO-ORDINATOR	COMPLETED	
		DESIGNER
I CERTIFY THAT THE WORKS HAVE BEEN CONSTRUCTED IN ACCORDANCE WITH THE WORK AS CONSTRUCTED DRAWINGS.		

PIPE SCHEDULE				
SIZE DN	TYPE	CLASS	LENGTH	PIPE JOINING METHOD / NOTES
100	o.P.V.C.	PN16	210.0	R.R.J.
DESIGN HEAD 120 m				

AUSTRALIAN HEIGHT DATUM	
SCALES	
PLAN 1:500	SECTION { HOR. . . . . VERT. . . . . }
CROSS SECTIONS . . . . . NATURAL	
LENGTHS, DEPTHS & LEVELS ARE IN METRES.	

NO AMENDMENTS ARE TO BE MADE TO THIS PLAN WITHOUT REFERENCE TO SYDNEY WATER. THIS PLAN IS NOT NECESSARILY UP TO DATE OR CORRECT AND SYDNEY WATER ACCEPTS NO RESPONSIBILITY.  
 U.B. DIRECTORY Map 266 N2 41st Edition  
 SHEET . 1 . OF . 1 . File No. N/A

**Sydney WATER** SYDNEY WATER CORPORATION  
 Case No.170649PW  
 WATERMAIN EXTENSION  
 STREETS OFF FIFTEENTH AVE  
 AUSTRAL LIVERPOOL

PLAN DRAWN DATE: 30.04.20  
 VERSION: C  
 SHEET 1 OF 1 SHEETS