

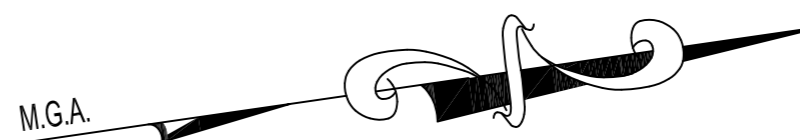

PO BOX 3222, REDFERN, NSW, 2016
Ph: (02) 8065 1156
Fax: (02) 8065 1297
Email: survey@daw-walton.com.au

3011
D P 1 2 2 6 4 4 1



351
D P 2 4 7 5

350
D P 2 4 7 5

349
D P 2 4 7 5

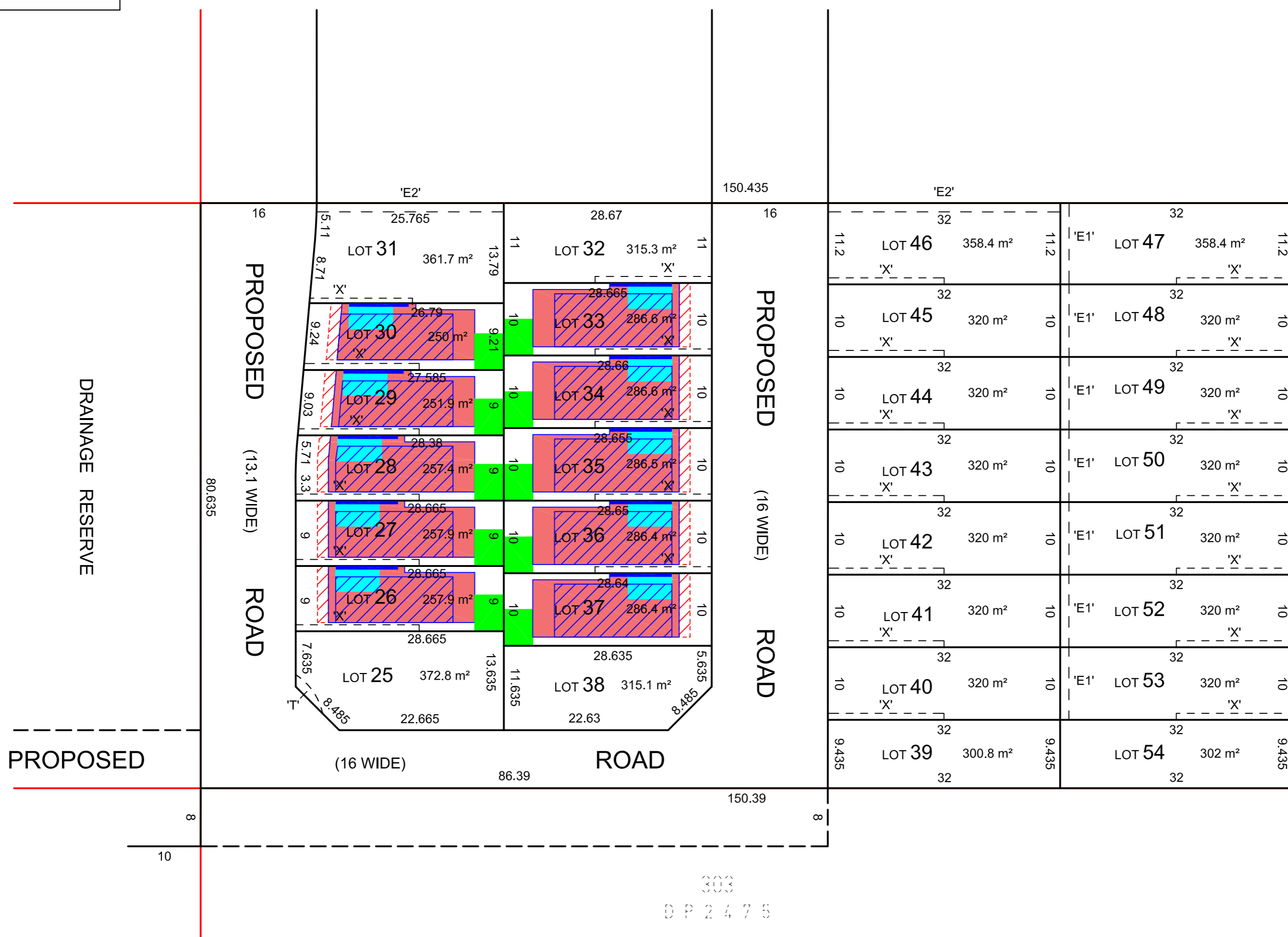

- 'T' DENOTES TEMPORARY RIGHT OF CARRIAGEWAY, VARIABLE WIDTH
- DENOTES PROPOSED GROUND FLOOR BUILDING ENVELOPE
- DENOTES PROPOSED LEVEL 2 BUILDING ENVELOPE
- DENOTES PROPOSED ARTICULATION ZONE
- DENOTES PROPOSED ZERO LOT LENGTH
- DENOTES PROPOSED PRINCIPAL PRIVATE OPEN SPACE (4 x 5m)
- DENOTES PROPOSED GARAGE POSITION

'X' DENOTES EASEMENT FOR REPAIRS 0.9 WIDE
'E1' DENOTES EASEMENT FOR DRAINAGE OF WATER, 1.2 WIDE
'E2' DENOTES EASEMENT FOR DRAINAGE OF WATER, 1.5 WIDE

PROPOSED PLAN OF SUBDIVISION AND BUILDING ENVELOPES

SURVEYOR: JOHN WALTON DATE OF SURVEY: 27 AUG 2018 SURVEYOR'S REF: 3900-17DP	PLAN OF: PROPOSED SUBDIVISION OF LOT 302 IN DP2475	LGA: LIVERPOOL LOCALITY: AUSTRAL SUBDIVISION No: Lengths are in metres. Reduction Ratio 1 : 500	REGISTERED:	DP
---	--	--	-------------	----